

# FLSRV Newsletter



Winter  
2022

W  
I  
N  
T  
E  
R



Inside This Issue	Valley Cleanup .....	Page 1	Classic Car Show .....	Page 2	Membership Form .....	Page 5
	Annual Meeting.....	Page 1	Midway Summer Auction/Dinner .....	Page 2	Trails Committee Update.....	Page 7
	Membership.....	Page 1	Take a Hike!.....	Page 3	Interview with Rose Richardson .....	Page 7
	Colbert Road Bridge Replacement .....	Page 2	Haynes Conservation Area.....	Page 4	Donor Thank You.....	Page 8

## Valley Clean-Up 2022

David Maccini

Friends of the Little Spokane River Valley held our annual cleanup day on April 23, 2022. We had about 25-30 people meet at Moose Park and help pick up garbage throughout the valley. We covered Shady Slope, Little Spokane Dr. from Dartford to Perry Rd., Midway Rd., Wandermere Rd., Hatch Rd., Colbert Rd. and Dartford Rd. We collected a slightly smaller volume, but quite a large variety of trash items.

Following the cleanup, many of us met at Haggin's house for the annual chili feed and fellowship with our neighbors. A big thank you to those who provided the chili, combread, and cookies.

Thank you to all who pitched in to help this year including Sgt. Atchison and his work crew from the county corrections department for hauling the trash away.

Please mark your calendars for the next cleanup, on April 22, 2023.

**We appreciate your support and help in keeping our valley**



## Annual Meeting and Dinner/Auction Friday, February 17, 2023 Wandermere Golf Club

Harla Jean Bieber

Your board is looking forward to a renewal of our annual get-together. We will enjoy Italian Food as we did in February of 2020. So, see your long-time friends and your new neighbors. Enjoy the opportunity to purchase wonderful auction items. Please make it a point in your life to come this year and celebrate our beautiful Valley.

Our speaker will be Ben Peterson, a Forester with the Spokane CD, who has been with the district for 21 years in many capacities. He currently runs the Firewise program and the Spokane Conservation Districts Annual tree sale. Ben is a certified Arborist, and Certified tree risk assessor.

Board members serve two year terms and will be elected

Please make your reservations by returning the form at the bottom of the enclosed membership page along with your money for dinner tickets.

*If you have items you would like to contribute to the auction please call*

Harla Jean 993-4775



## Membership

*A 2023 membership form is enclosed for your convenience.*

In 2022 we had over 100 member families. Membership money goes into a general fund and provides the resource for printing and mailing newsletters, maintaining our web site, auditing of each years financial records and other miscellaneous expenses.

**We have created these options:**

- OTTER - Annual family (two membership votes within the area) – \$25/year
- DEER - Annual family “plus” support – \$60/year
- HERON - Annual family plus monthly donation support – \$10/month

*Your support is important so please complete the enclosed Membership Form.*

*Friends of Little Spokane River Valley, Inc.*

---

## FLSRV Newsletter

is a publication of:  
**Friends of Little Spokane River Valley, Inc.**  
 P.O. Box 18191  
 Spokane, WA 99228  
 Phone: 509-951-2084

For article suggestions or comments contact Harla Jean Bieber

---

### Board of Directors

Martha Schaefer, President  
 Dave Maccini, Vice President  
 Lindell Haggin, Secretary  
 Harla Jean Bieber, Treasurer  
 Mark Case, Director  
 Michael Kennedy, Director  
 Kirk Neumann, Director  
 Tina Wynecoop, Director  
 Lance Pounder, Director  
 Jack Bury, Director Emeritus

# COLBERT ROAD BRIDGE No. 3703 REPLACEMENT

*Tina Wynecoop*

The Little Spokane River is fed by a generous watershed which contributes meltwaters, freshets, the aquifer, and smaller streams to its wellbeing. Eventually and continuously its watershed contributes to the even larger Spokane and Columbia Rivers' watersheds. Our namesake LSR meanders and wanders a lot as it moves through our organization's namesake valley. Bridges, some large, most small dot the landscape.

The Little Spokane River has several two-lane bridges crossing over the river's path it takes from its source near Newport to far downstream at its confluence with the Spokane River near the Spokane House. Locally the bridges at Dartford, Golden Rd, and Wandermere have been replaced. Other bridges are awaiting their turn. It is time, maybe past time, for this to happen.

Spokane County is focused on its replacement plans for three local bridges, including Colbert Rd. Bridge. Funding

Recently, Mike Duke, PE, Bridge Program Manager for Spokane County Public Works, informed residents living near Colbert Road Bridge #3703, located just east of where Colbert Rd. intersects with Little Spokane Dr, that preliminary survey work was scheduled this Fall for the bridge's planned replacement in 2026/2027.

The FLSRV Board of Directors invited Mr. Duke to our October meeting to learn more, and to share our concerns about pedestrian safety (or lack of) when attempting to cross any of these older bridges designed for cars, not pedestrians. Currently our trail pathways lead up to bridges where the "crossing over places" take a backward step regarding safe passage. We asked the engineer if there were any grant possibilities that might help fund the design and construction of future bridges for cars and pedestrians. Mike informed the board of possible resources and grant information to pursue. (Wandermere, Dartford and Golden Road bridges are pedestrian friendly.)

We are pleased to learn that future replacement bridges will reflect the county's understanding of the importance of river/human interchange. Connection and respect for the river is obscured when there is no visibility. To date, only the Wandermere Bridge allows this connectivity with its open concrete railings. Bridges will all be designed so the river is visible through the railings.

Our board meeting with Mike Duke closed with both relief and appreciation that the county and the FLSRV community share the same aspirations and values.

## Midway Summer 2022 Auction/Dinner



---

## Classic Car Show

---

In the Midway School parking lot Mark Case put on a show of "classic car parking". It had some fine looking rides and it was nice for people to see them. He was pleased to share stories with some of our neighbors.



# TAKE A HIKE!

Tina Wynecoop

The FLSRV Trails system continues to grow and enhance our community. There is a new addition to our non-motorized pedestrian trail. Twenty-plus years ago the Friends of the Little Spokane Valley Board of Directors and its trails subcommittee dreamed of and designed a trail system throughout the Little Spokane River Valley. The community was invited to participate which it did wholeheartedly. The community wanted trails, it wanted places to walk with connections with schools, neighborhoods, churches, malls, parks, etc. The Board did too! At that time Spokane County included our plans for walkable trails in its Comprehensive Plan.

All these years later, our non-motorized trail system has extended from zero to more than 25 miles. Donations, memberships, grants, and pure hard labor by many volunteers have made the trails vision a solid reality - and pretty darn special, safe and healthful as well. (A downloadable map of the trails is available at [FLSRV.org](http://FLSRV.org))

Have you seen the new, separated-from-the-road asphalt pathway? It begins at Wandermere Rd. East along the northside of Little Spokane Connector Road down to the current pathway at Little Spokane Drive. The new trail has been built right under our noses without our designing, permit applying, building, or fund-raising. It is foot-ready. It is gorgeous. It replaces a significant missing gap in the trail system. The trail can now be circumnavigated from the Aquatic Center on N. Hatch Rd. to the Little

Spokane River at Wandermere Bridge, on past Pine River Park, continuing upstream to Midway Road. (Soon the trail will be extended along Little Spokane Drive beyond the juncture of Little Spokane Dr./ Midway Rd. north to Colbert Rd. which is partially completed.)

Who do we thank? The project was submitted for grant funding by Spokane County with the support of Friends of the Little Spokane River Valley in 2015. According to Brandi Colyar P.E., Capital Projects Program Manager for Spokane County Public Works: "Your ability to demonstrate community support

by showing that it was included in your master plan was beneficial to the project selection" The Spokane Regional Transportation Council set aside funding and received more funding from the Surface Transportation Block Grant. The county contributed additional funding. Total cost for this project: \$542,100. FLSRV's logo of the striding, hiking-booted Blue heron is animated as the bird raises both wings in salute to the project's many contributors! And our community of humans salutes all involved with a glad "thank you" too!

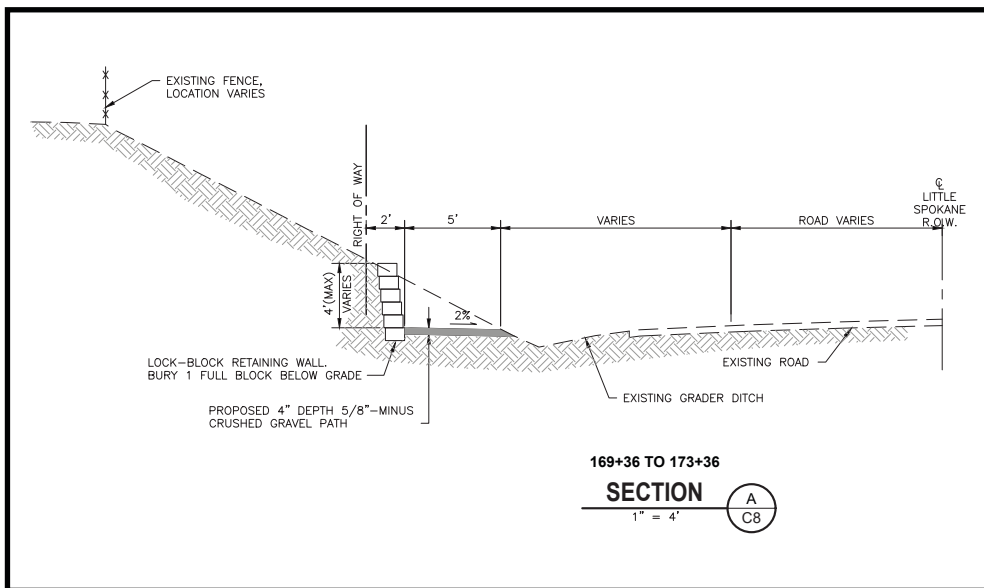

# The Creation of the Haynes Conservation Area

*Ty Brown*

Around 1950, Edward and Eloise Haynes purchased nearly 90 acres of land along the Little Spokane River. The property was situated between Shady Slope Road and Pine River Park. Although they lived in Spokane, they built a small shed on the banks of the river with the intention of eventually moving to the acreage. In 1961, the couple's son, Don Haynes acquired a portion of the land and soon built a home on the property. The younger Haynes raised his own family on the property until his children grew up and moved away. Their home was located up the hill from the river. All that remains of the home is an old wagon that adorned the circular driveway and the well house, as it was torn down by the County soon after becoming a conservation area.

In the mid-1970s, Edward and Eloise passed away, and around this time Don Haynes constructed a home on the site of the original shed on the banks of the river. This home (still standing) was built by Haynes in an unusual "Spanish" style. Soon after the construction was complete, he rented out the home. He also rented out his family home further in the woods of the sprawling property. By the mid-1980s, Haynes had the idea to develop the land in order to afford the property taxes that were mounting on such a large piece of property. He platted out what would be known as the Haynes Estates housing development. This caused an uproar with the surrounding neighbors over plans to develop near the Little Spokane River. With the help of the Friends of the Little Spokane River and the Inland Northwest Land Conservancy, the property was purchased in 2001 by Spokane County through the Conservation Futures Program in order to avoid development.

Don Haynes passed away in 1999 before he was able to see this land turned into a natural area to be enjoyed by thousands of people. The Spanish-style home was rented out by the County for several years but now stands vacant. Plans may be in the works to turn it into an outdoor-educational learning center. His children helped make this all possible, along with nearby landowners that sold adjacent properties in order to keep these nearly 100 acres a habitat for wildlife and recreation. Spokane County maintains the land through an endowment set up by the Haynes children, who donated \$242,00 to be used for restoration, enhancement, and long-term care of the property.

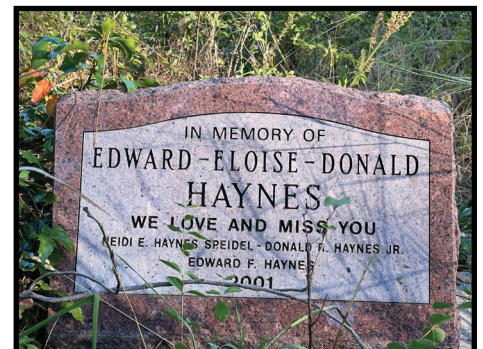

## Friends of the Little Spokane River Valley, Inc. 2023 Association Membership Form

### Goals of the organization:

- ⇒ Preserve and sustain the unique character of the Little Spokane River Valley, including its open space and natural setting, maintaining lower density zoning.
- ⇒ Protect the areas ecosystem including water quality, wetlands, priority habitat and wildlife, and dwindling native vegetation.
- ⇒ Encourage the development of area parks.
- ⇒ Educate public officials of FLSRV concerns, being pro-active when major issues are at the forefront.

Property owners in the area *3/4 mile either side of the Little Spokane River from Chattaroy to Dartford, then 1/2 mile either side of the Little Spokane River from Dartford to the Fish Hatchery* are invited to become members. Each membership may include two members of one family. Individuals who live outside the designated area, or any organization, may join as an Associate (non-voting) member.

**Being in agreement with the goals, I wish to join FLSRV.** Signature \_\_\_\_\_

Name (or Organization): \_\_\_\_\_

Address: \_\_\_\_\_

City: \_\_\_\_\_ State: \_\_\_\_\_ Zip Code: \_\_\_\_\_

Cell Phone : \_\_\_\_\_ E-Mail : \_\_\_\_\_

What are your special concerns about the valley?

What issues or topics would you like discussed at meetings?

<p><b>Check if you are interested in helping with:</b></p> <p><input type="checkbox"/> Trails Committee                      <input type="checkbox"/> Grant Writer</p> <p><input type="checkbox"/> Parks Committee</p> <p><input type="checkbox"/> Newsletter (writing &amp;/or publishing)</p> <p><input type="checkbox"/> Sign Design or construction</p> <p><input type="checkbox"/> Board member</p> <p><input type="checkbox"/> Administrative help</p> <p><input type="checkbox"/> Other _____</p>	<p style="text-align: center;"><b>2023 FLSRV Membership Dues:</b></p> <p>Otter - Annual Family Membership (2 membership votes within area)                      \$25.00</p> <p>Deer - Annual Family "Plus" Support (\$60/year)                      \$ _____</p> <p>Heron - Annual Family Plus Monthly Donation (\$10/mo)                      \$ _____</p> <p>Associate Member \$15.00                      \$ _____</p> <p>Welcome Sign (Future)                      \$ _____</p> <p>Trail Fund Contribution                      \$ _____</p> <p style="text-align: center;"><b>TOTAL PAID</b>                      \$ _____</p>
--	--

Friends of Little Spokane River Valley, Inc. is an IRS Section 501(c)(3) tax-exempt non-profit corporation (a charity). Dues and donations are tax exempt to the full extent of the law. You should check with your tax consultant to be sure this applies to you.

Make checks payable to: **Friends of Little Spokane River Valley**  
Mail to: **Harla Jean Bieber, 2220 E. Colbert Rd., Colbert, WA 99005**

<b>FLSRV Dinner Reservation</b>		Friday, February 17th, 2023, Doors Open 5:30pm, Meeting 6:30pm, Dinner 7:00pm <b>Wandermere Golf Course Clubhouse</b>	
# Tickets requested <b>(\$30.00 Each)</b>	Name(s):		
Amount enclosed: \$	Street:	City:	Zip:
Make checks payable to <b>FLSRV</b> . Donations may be tax deductible.			Phone:
Send to: <b>Harla Jean Bieber</b> 2220 E. Colbert Rd. Colbert, WA 99005		<b>Pick up your tickets at the door.</b>	

THIS PAGE INTENTIONALLY LEFT BLANK

# TRAILS COMMITTEE UPDATE

Mark Case

Trail design update for the west side of Little Spokane Drive from Midway Road to Colbert Road is progressing slowly. I updated the drawing set per comments from Spokane County in June 2021 but waiting to secure some of the easements we need before we can resubmit the set. We've had a couple residences change hands and unable to get the easement through the cattails for the boardwalk, so we are looking at different options for that.

Last spring, we built the continuation of the trail we started one year ago beginning at the Colbert Road intersection, we had two trees removed and were able to ramp up the hill having the trail along the edge of the bank and still be within the right of way; it continues all the way down to View Lane. At View Lane, however there is an existing culvert crossing under Little Spokane Drive that is mostly silted in, we are still impatiently waiting for the county road maintenance to blast it out before we can install our catch basin and extend a culvert under the new trail, hoping to accomplish that this fall (not looking good).

The next piece south of View Lane to River View Drive will require a retaining wall and some soil relocation to another part of the trail (to be determined).

We are also looking at starting the piece at the Northwest corner of Midway that ramps up the hillside and goes along the top, waiting for another easement to be secured for that so we can save more trees and stay on what appears to be an old road that already exists across that property, will see what happens there.

We continue to depend on donations and look for grants, the grants are very specific and difficult to meet all the criteria to be able to apply for them, so we continue our search.

*Hope you are getting out there and enjoying the trails we have completed so far!*



## INTERVIEW WITH INLC STEWARDSHIP DIRECTOR ROSE RICHARDSON

*Kirk Neumann*

- Notice -

Bridge closure at Waikiki Springs Nature Preserve, late October- November 2022

The pedestrian bridge at Waikiki Springs Nature Preserve is being re-widened to accommodate maintenance or fire vehicles. The property will be the subject of significant habitat restoration and native fish reintroduction efforts and to do that work effectively and efficiently, we need to be able to bring vehicles onto the property from time to time. Bollards, large removable posts, will be installed to prohibit unauthorized vehicles from passing over the bridge onto INLC property. When will the Waikiki Springs bridge be closed? How long?

The bridge will be closed in late fall (late October thru the end of November). We don't know the exact dates yet but will update trail users as soon as we have firm dates. A lot of the work is dependent on permits, which were dependent on the plans that were just finished. As soon as those permits are approved, the construction crews will begin their work. We expect the bridge to be closed for about four weeks. What does this mean for trail users? Will there be access to the

preserve during construction?

Unfortunately, during this construction window, access to the preserve will be fully closed. It is important to stay off of the bridge, even when crews are not at work to prevent injury from construction materials or loose bridge components. As soon as the construction crews have completed their work, pedestrian traffic is welcome to return to normal use, but until then, it's important to stay on the south side of the river. Please do not try to find alternative routes across the river to access the property. Doing so could damage important habitat features like shallow draws where young fish rear, beaver dens, wet meadows that are important for amphibian hibernation or create social trails that we try very hard to keep from forming.

Who is doing the work? What exactly are they doing? We've worked with several environmental consultants, engineers, and WDFW biologists to get the bridge work planned and approved. But the ultimate construction work will be done by Garco Construction.



**TIS THE SEASON**



Friends of  
 Little Spokane River Valley, Inc.  
 P.O. Box 18191  
 Spokane, WA 99228



**Midway Summer 2022 Auction  
 Donors and Attendees**

*Tina Wynecoop*

**- WARNING -**

This newsletter contains dangerously high levels of gratitude.

You certainly made our outdoor Midway School dinner/auction a success with your support:

- The UPS Store
- Pounder's Jewelry
- Car Wash Plaza
- Birdy's Sports Bar
- Ritters Garden & Gift
- Wynecoop family

- Starbucks
- Ty Brown
- Jack Nisbet
- Robert Ellis
- Lindell Haggin
- Wandermere Golf Course
- The Man Shop
- North Division Bicycle
- Sety's Ace Hardware
- Colbert Trading Company

- Carrie Dugovic
- A Taste of Thai
- Harla Jean Biever
- Alicia Sullivan
- Irene Byrd
- Wonderland Family Fun Center
- Little Spokane Garden Club
- Boy Scout Troop #218
- Inchelium Cultural Research Center
- Valvoline Instant Oil Change

Thank you, too, to the volunteers and members who worked hard behind the scene to put on this community event.

The unexpected windstorm that came up and blew everything off the tables is recognized, but *not* thanked.